

LANDCON

LIFTING EQUIPMENT AND CONCRETE ACCESSORIES

STARCON
LIFTING
ANCHORS

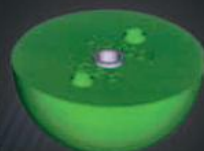

2023

SERVING THE INDUSTRY SINCE 1991

www.landconproducts.com



SAFETY

QUALITY

SERVICE

Contents

| | | | |
|--|------------|--|------------|
| Starcon Anchor System | page 3-6 | Korlath® Bearing Pads & Shims | page 14-15 |
| Starcon Lifting Eyes | page 7 | Plastic Spacers | page 16-18 |
| Formers and Steelparts | page 8 | BSV Lifting Equipment | page 19-21 |
| Ring Clutches | page 9 | Maintenance Steps | page 22 |
| Starcon Utility & Type R Anchors . . . | page 10 | Fairport Paver/Block Splitters | page 23 |
| Barsplice Couplers & Rebar | page 11-13 | Extreme Bond Adhesive & Spikes . . . | page 23 |

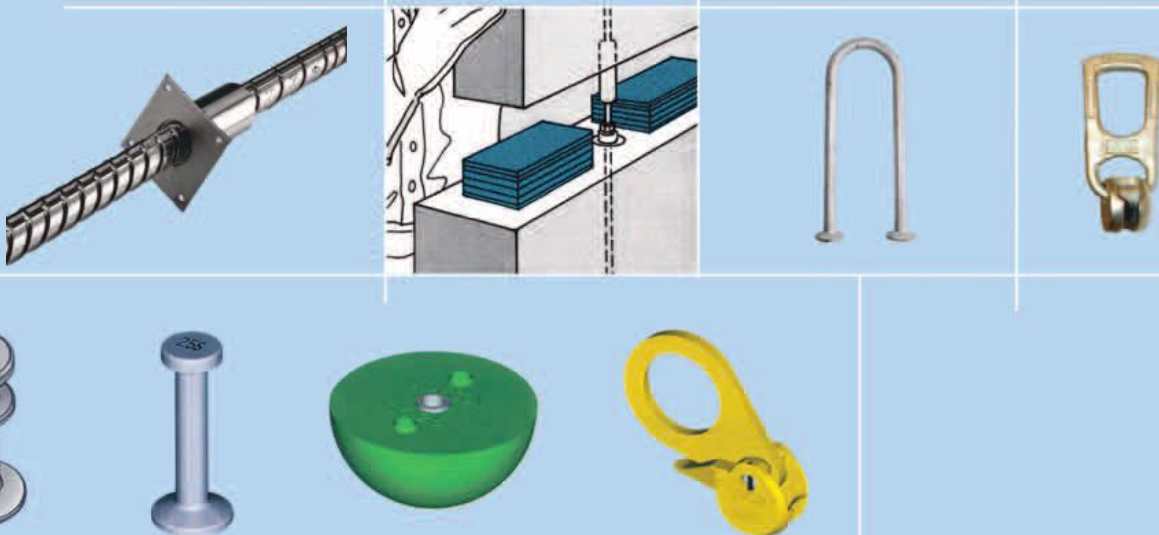

Starcon Anchor System

Landcon is the North American Distributor for the Starcon Anchor System. The entire line of Starcon lifting products, which we import from Denmark, consists of a complete lifting program for handling concrete panels and pipes: Starcon Anchors, Starcon Lifting Eyes and Starcon Formers are available for safe load ratings between 1T and 20T.

The Starcon Anchor System has been thoroughly tested, is well documented, and meets all demands for quality and safety. It can be used in combination with other systems, provided that the products meet the same demands as the Starcon products in regards to material, strength, and dimensions.

The Starcon Anchor System goes through an extensive quality control program before the products leave the factory. Starcon is ISO 9001-2000 certified and covered by a worldwide insurance policy.

In Addition we have experienced engineers, who are able to calculate choice, position, and lifting strategies for the Starcon Anchors. This service is offered to our customers free of charge.

Starcon Lifting Anchors



| Product | Ton | Anchor Head Mark | Length IN | Length mm | Dimensions (mm) | | | Weight kg |
|---------|-----|------------------|--------------|--------------|-----------------|----|----|-----------|
| | | | | | d | d1 | d2 | |
| 1010400 | 1 | 1.3 | 1 1/2" | 40mm | 10 | 19 | 25 | 0.05 |
| 1010550 | 1 | 1.3 | 2 1/4" | 55mm | 10 | 19 | 25 | 0.07 |
| 1010650 | 1 | 1.3 | 2 1/2" | 65mm | 10 | 19 | 25 | 0.07 |
| 1010850 | 1 | 1.3 | 3 3/8" | 85mm | 10 | 19 | 25 | 0.08 |
| 1010200 | 1 | 1.3 | 4 3/4" | 120mm | 10 | 19 | 25 | 0.01 |
| 1012400 | 1 | 1.3 | 9 1/2" | 240mm | 10 | 19 | 25 | 0.17 |

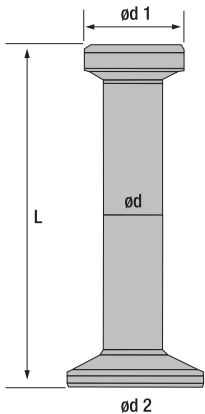

| Product | Ton | Anchor Head Mark | Length IN | Length mm | Dimensions (mm) | | | Weight kg |
|---------|-----|------------------|--------------|--------------|-----------------|----|----|-----------|
| | | | | | d | d1 | d2 | |
| 1030450 | 2 | 2.5 | 1 3/4" | 45mm | 14 | 26 | 35 | 0.12 |
| 1030550 | 2 | 2.5 | 2 1/4" | 55mm | 14 | 26 | 35 | 0.13 |
| 1030680 | 2 | 2.5 | 2 3/4" | 68mm | 14 | 26 | 35 | 0.15 |
| 1030850 | 2 | 2.5 | 3 3/8" | 85mm | 14 | 26 | 35 | 0.17 |
| 1031000 | 2 | 2.5 | 4" | 100mm | 14 | 26 | 35 | 0.18 |
| 1031200 | 2 | 2.5 | 4 3/4" | 120mm | 14 | 26 | 35 | 0.19 |
| 1031400 | 2 | 2.5 | 5 1/2" | 140mm | 14 | 26 | 35 | 0.21 |
| 1031700 | 2 | 2.5 | 6 3/4" | 170mm | 14 | 26 | 35 | 0.23 |
| 1032800 | 2 | 2.5 | 11" | 280mm | 14 | 26 | 35 | 0.27 |

Starcon Lifting Anchors

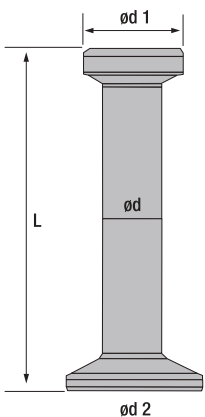

| Product | Ton | Anchor Head Mark | Length IN | Length mm | Dimensions (mm) | | | Weight kg |
|---------|-----|------------------|--------------|--------------|-----------------|----|----|-----------|
| | | | | | d | d1 | d2 | |
| 1050650 | 4 | 5.0 | 2 1/2" | 65mm | 20 | 36 | 50 | 0.32 |
| 1050750 | 4 | 5.0 | 3" | 75mm | 20 | 36 | 50 | 0.34 |
| 1050850 | 4 | 5.0 | 3 3/8" | 85mm | 20 | 36 | 50 | 0.36 |
| 1050880 | 4 | 5.0 | 3 1/2" | 88mm | 20 | 36 | 50 | 0.38 |
| 1050950 | 4 | 5.0 | 3 3/4" | 95mm | 20 | 36 | 50 | 0.40 |
| 1051100 | 4 | 5.0 | 4 1/4" | 110mm | 20 | 36 | 50 | 0.43 |
| 1051200 | 4 | 5.0 | 4 3/4" | 120mm | 20 | 36 | 50 | 0.46 |
| 1051340 | 4 | 5.0 | 5 1/4" | 134mm | 20 | 36 | 50 | 0.48 |
| 1051400 | 4 | 5.0 | 5 1/2" | 140mm | 20 | 36 | 50 | 0.49 |
| 1051500 | 4 | 5.0 | 5 7/8" | 150mm | 20 | 36 | 50 | 0.52 |
| 1051600 | 4 | 5.0 | 6 1/4" | 160mm | 20 | 36 | 50 | 0.56 |
| 1051800 | 4 | 5.0 | 7 1/8" | 180mm | 20 | 36 | 50 | 0.61 |
| 1052100 | 4 | 5.0 | 8 1/4" | 210mm | 20 | 36 | 50 | 0.69 |
| 1052400 | 4 | 5.0 | 9 1/2" | 240mm | 20 | 36 | 50 | 0.76 |
| 1053400 | 4 | 5.0 | 13 3/8" | 340mm | 20 | 36 | 50 | 1.01 |
| 1054800 | 4 | 5.0 | 18 7/8" | 480mm | 20 | 36 | 50 | 1.36 |

| Product | Ton | Anchor Head Mark | Length IN | Length mm | Dimensions (mm) | | | Weight kg |
|---------|-----|------------------|--------------|--------------|-----------------|----|----|-----------|
| | | | | | d | d1 | d2 | |
| 1070850 | 6 | 7.5 | 3 3/8" | 85mm | 24 | 47 | 60 | 0.51 |
| 1071200 | 6 | 7.5 | 4 3/4" | 120mm | 24 | 47 | 60 | 0.73 |
| 1071400 | 6 | 7.5 | 5 1/2" | 140mm | 24 | 47 | 60 | 0.81 |
| 1071500 | 6 | 7.5 | 5 7/8" | 150mm | 24 | 47 | 60 | 0.84 |
| 1071650 | 6 | 7.5 | 6 1/2" | 165mm | 24 | 47 | 60 | 0.89 |
| 1072000 | 6 | 7.5 | 7 7/8" | 200mm | 24 | 47 | 60 | 1.01 |
| 1073000 | 6 | 7.5 | 11 7/8" | 300mm | 24 | 47 | 60 | 1.36 |
| 1075400 | 6 | 7.5 | 21 1/4" | 540mm | 24 | 47 | 60 | 2.24 |
| 1076800 | 6 | 7.5 | 26 3/4" | 680mm | 24 | 47 | 60 | 2.60 |

| Product | Ton | Anchor Head Mark | Length IN | Length mm | Dimensions (mm) | | | Weight kg |
|---------|-----|------------------|--------------|--------------|-----------------|----|----|-----------|
| | | | | | d | d1 | d2 | |
| 1101200 | 8 | 10.0 | 4 3/4" | 120mm | 28 | 47 | 70 | 0.93 |
| 1101350 | 8 | 10.0 | 5 1/4" | 135mm | 28 | 47 | 70 | 1.03 |
| 1101500 | 8 | 10.0 | 5 7/8" | 150mm | 28 | 47 | 70 | 1.09 |
| 1101600 | 8 | 10.0 | 6 1/4" | 160mm | 28 | 47 | 70 | 1.14 |
| 1101700 | 8 | 10.0 | 6 3/4" | 170mm | 28 | 47 | 70 | 1.18 |
| 1101800 | 8 | 10.0 | 7 1/8" | 180mm | 28 | 47 | 70 | 1.23 |
| 1102100 | 8 | 10.0 | 8 1/4" | 210mm | 28 | 47 | 70 | 1.44 |
| 1102200 | 8 | 10.0 | 8 3/4" | 220mm | 28 | 47 | 70 | 1.49 |
| 1102500 | 8 | 10.0 | 10" | 250mm | 28 | 47 | 70 | 1.56 |
| 1103400 | 8 | 10.0 | 13 3/8" | 340mm | 28 | 47 | 70 | 1.98 |
| 1106800 | 8 | 10.0 | 26 3/4" | 680mm | 28 | 47 | 70 | 3.57 |



| Product | Ton | Anchor Head Mark | Length IN | Length mm | Dimensions (mm) | | | Weight kg |
|---------|-----|------------------|--------------|--------------|-----------------|----|----|-----------|
| | | | | | d | d1 | d2 | |
| 1151650 | 12 | 15.0 | 6 1/2" | 165mm | 34 | 70 | 85 | 1.97 |
| 1152000 | 12 | 15.0 | 7 7/8" | 200mm | 34 | 70 | 85 | 2.21 |
| 1153000 | 12 | 15.0 | 11 7/8" | 300mm | 34 | 70 | 85 | 2.91 |
| 1154000 | 12 | 15.0 | 15 3/4" | 400mm | 34 | 70 | 85 | 3.59 |
| 1202000 | 20 | 20.0 | 7 7/8" | 200mm | 39 | 70 | 98 | 2.7 |
| 1202500 | 20 | 20.0 | 10" | 250mm | 39 | 70 | 98 | 3.3 |
| 1203400 | 20 | 20.0 | 13 3/8" | 340mm | 39 | 70 | 98 | 4.38 |
| 1205000 | 20 | 20.0 | 19 3/4" | 500mm | 39 | 70 | 98 | 5.87 |
| 1210000 | 20 | 20.0 | 39 1/2" | 1000mm | 39 | 70 | 98 | 11.75 |

Specialty Anchors

Double Headed Anchors



| Product | Ton | Anchor Head Mark | Length IN | Length mm | Weight kg |
|-----------|-----|------------------|--------------|--------------|--------------|
| 1030550DH | 2 | 2 | 2 1/4" | 55mm | 0.12 |
| 1030850DH | 2 | 2 | 3 3/8" | 85 mm | 0.16 |
| 1030120DH | 2 | 2 | 4 3/4" | 120mm | 0.21 |
| 1030170DH | 2 | 2 | 6 3/4" | 170mm | 0.27 |
| 1050650DH | 4 | 4 | 2 1/2" | 63.5 mm | 0.34 |
| 1050900DH | 4 | 4 | 3 1/2" | 90 mm | 0.40 |
| 1050110DH | 4 | 4 | 4 1/4" | 110 mm | 0.46 |
| 1050140DH | 4 | 4 | 5 1/2" | 140mm | 0.54 |

Custom sizes available

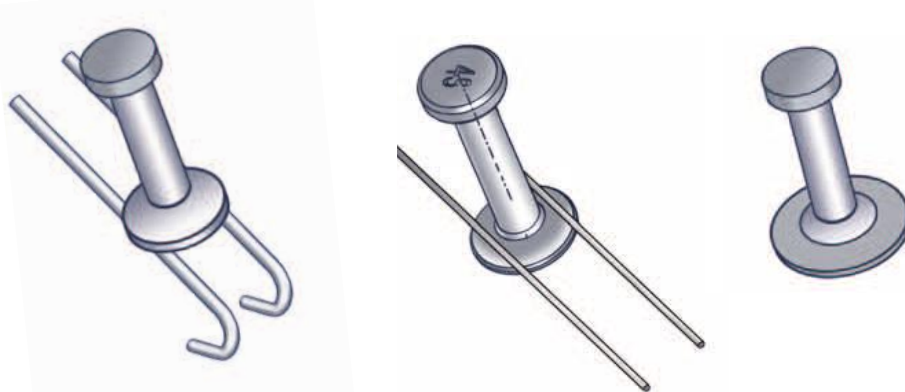

Custom Welded Anchors Available

Safety factor approximately 4:1

Anchors available hot-dipped galvanized

1 ton = 2000 lbs.

Eye Anchors

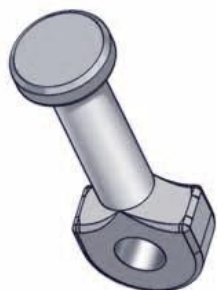

| Product | Ton | Anchor Head Mark | Length IN | Length mm | Weight kg |
|------------|-----|------------------|--------------|--------------|--------------|
| 1030900EYE | 2 | 2.5 | 3 1/2" | 90 mm | 0.18 |
| 1040120EYE | 4 | 5 | 4 3/4" | 120 mm | 0.43 |
| 1101150EYE | 8 | 10.0 | 4 1/2" | 115 mm | 0.9 |
| 1101800EYE | 8 | 10.0 | 7 1/8" | 180 mm | 1.23 |
| 1202500EYE | 20 | 20.0 | 10" | 250 mm | 3.3 |

Tension Bar

For use with the Eye Anchors.

Available in standard dimensions for 2T-20T capacity.

Custom dimensions / bends available.

All rebar MTO DSM material.

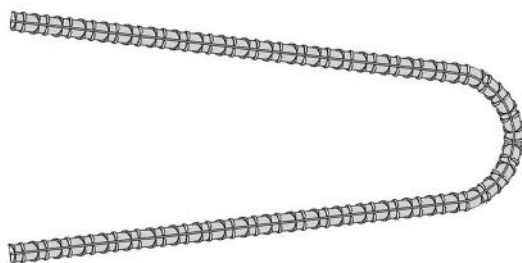

Shear Bar

Available in standard dimensions for 2T-20T capacity.

Custom dimensions available.

All rebar MTO DSM material.



Starcon Lifting Eyes are designed for years of safe and efficient use. Starcon Lifting Eyes can be used in combination with other dog-bone style anchors, provided they meet the same standards as the Starcon products in regard to material, strength, and dimensions.

Before leaving the factory a number of checks are performed insuring that every lifting eye complies with our strict standards. The material and dimensional specifications are checked. From there, random lifting eyes undergo destructive testing to confirm their ultimate capacity. Following that, every lifting is bench tested to twice the safe working load, stamped with a serial number, and issued a test certificate. These checks help to insure the safety of you, and your customers.



Starcon Lifting Eye With Standard Link

| Product | Tons | Lifting Body Mark | Safe Work Load lbs. | Weight kg |
|---------|-------|-------------------|------------------------|-----------|
| 2010131 | 1 | 1.0 / 1.3 T | 2000 | 1 |
| 2030251 | 2 | 1.5 / 2.5 T | 4000 | 2 |
| 2050501 | 4 | 3.0 / 5.0 T | 8000 | 3 |
| 2101001 | 8 | 6.0 / 10.0 T | 16000 | 10 |
| 2202001 | 12-20 | 12.0 / 20.0 T | 40000 | 18 |



Starcon Lifting Eye With Chain Link

| Product | Tons | Lifting Body Mark | Safe Work Load lbs. | Weight kg |
|---------|-------|-------------------|------------------------|-----------|
| 2010133 | 1 | 1.0 / 1.3 T | 2000 | 1 |
| 2030253 | 2 | 1.5 / 2.5 T | 4000 | 2 |
| 2050503 | 4 | 3.0 / 5.0 T | 8000 | 3 |
| 2101003 | 8 | 6.0 / 10.0 T | 16000 | 10 |
| 2202003 | 12-20 | 12.0 / 20.0 T | 40000 | 18 |



"DEHA/Dayton" Style Lifting Eye

| Product | Tons | Lifting Body Mark | Safe Work Load lbs. | Weight kg |
|---------|-------|-------------------|------------------------|-----------|
| 590080 | 1 | 1.0 / 1.3 T | 2000 | 1 |
| 590081 | 2 | 1.5 / 2.5 T | 4000 | 2 |
| 590082 | 4 | 3.0 / 5.0 T | 8000 | 3 |
| 590083 | 8 | 6.0 / 10.0 T | 16000 | 10 |
| 590084 | 12-20 | 12.0 / 20.0 T | 40000 | 18 |

Please Note:

The Starcon lifting eyes should be checked once per year, or at the latest 12 months after the first use. They should be checked for possible damages and wear and tear. At considerable wear, stroke marks, or the like, the Starcon lifting eye should be scrapped. Modifications or repairs, especially weldings, of the Starcon lifting should never occur.

Safety factor is approximately 5:1

Starcon Formers

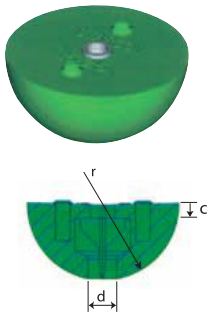

| Product | Tons | Marking | Color | Dimension mm | | | weight kg |
|---------|------|---------------|--------|--------------|----|----|-----------|
| | | | | d | r | c | |
| 3010130 | 1 | 1.0 / 1.3 T | Violet | 10 | 30 | 10 | 0.22 |
| 3030250 | 2 | 1.5 / 2.5 T | Green | 14 | 37 | 12 | 0.46 |
| 3050500 | 4 | 3.0 / 5.0 T | Red | 20 | 47 | 18 | 0.78 |
| 3070750 | 6 | 6.0 / 7.5 T | Orange | 24 | 59 | 19 | 1.48 |
| 3101000 | 8 | 8.0 / 10.0 T | Orange | 28 | 59 | 19 | 1.48 |
| 3151500 | 12 | 12.0 / 15.0 T | Gray | 34 | 80 | 20 | 3.2 |
| 3202000 | 20 | 16.0 / 20.0 T | Blue | 39 | 80 | 20 | 3.2 |

Threaded Bolt w/ Plate and Wingnut



| Product | Tons |
|---------|------|
| 3010130 | 1 |
| 4030250 | 2 |
| 4050500 | 4 |
| 4101000 | 6 |
| 4101000 | 8 |
| 4202000 | 12 |
| 4202000 | 20 |

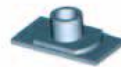

Threaded Nut w/ Plate

| Product | Tons |
|---------|------|
| 4010131 | 1 |
| 4030251 | 2 |
| 4050501 | 4 |
| 4101001 | 6 |
| 4101001 | 8 |
| 4202001 | 12 |
| 4202001 | 20 |

Starcon Steel Former



| Product | Tons | Marking |
|---------|------|-------------|
| 4510130 | 1 | 1.0 / 1.3 T |
| 4530250 | 2 | 1.5 / 2.5 T |
| 4550500 | 4 | 3.0 / 5.0 T |
| 4550010 | 8 | 6.0 / 10 T |

Starcon Grommets for Steel or Magnetic Former

| Product | Tons |
|----------|------|
| 4010213G | 1 |
| 4030225G | 2 |
| 4050250G | 4 |
| 4050275G | 6 |
| 4050275G | 8 |

Starcon Magnetic Steel Former



| Product | Tons | Marking |
|---------|------|-------------|
| 4011013 | 1 | 1.0 / 1.3 T |
| 4031025 | 2 | 1.5 / 2.5 T |
| 4050051 | 4 | 3.0 / 5.0 T |
| 4050010 | 8 | 6 / 10 T |



Ring Clutch with Solid Link

Ring Clutch with Solid Link consists of a bail, clutch and curved bolt handle. To install, rotate the curved bolt to the opened position and insert the clutch into the recess. To lock onto the anchor, rotate the curved bolt handle until the handle contacts the panel surface.

| Product | Tons | Safe Work Load | Lifting body mark | weight kg |
|-----------|------|----------------|-------------------|-----------|
| 56009025N | 2-3 | 6000lbs. | 2-3 | 2 |
| 56009050N | 4-6 | 12000 lbs. | 4-6 | 3 |
| 56009100N | 8-11 | 22000 lbs. | 8-12 | 8 |

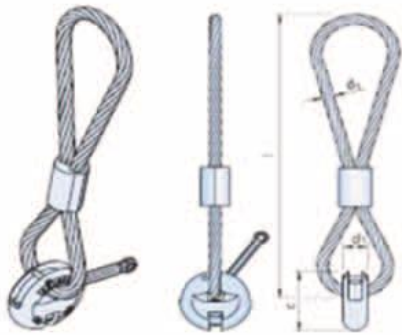

Ring Clutch with Steel Wire Rope

Ring Clutch with Steel Wire Rope consists of a cable, swage, clutch body and curved bolt handle. To install, rotate the curved bolt to the opened position and insert the clutch into the recess. To lock onto the anchor, rotate the curved bolt handle until the handle contacts the panel surface.

| Product | Tons | Safe Work Load | Lifting body mark | weight kg |
|-----------|------|----------------|-------------------|-----------|
| 56009025N | 2-3 | 6000lbs. | 2-3 | 2 |
| 56009050N | 4-6 | 12000 lbs. | 4-6 | 3 |
| 56009100N | 8-11 | 22000 lbs. | 8-12 | 8 |

Please Note:

The Starcon Ring Clutches should be checked once per year, or at the latest 12 months after the first use. They should be checked for possible damages and wear and tear. At considerable wear, stroke marks, or the like, the Starcon lifting eye should be scrapped. Modifications or repairs, especially weldings, of the Starcon lifting should never occur.

Safety factor is approximately 5:1

Utility Anchors



| Part Number | Anchor Identification | Typical Slab Thickness | WD-Wire Diameter | W-Width | H-Height | Fd - Foot Diameter |
|-------------|-----------------------|------------------------|------------------|---------|----------|--------------------|
| LUAG44 | 4/4 | 4" | .444 | 5-1/4" | 3-1/8" | 3/4" |
| LUAG54 | 5/4 | 5" | .444 | 6" | 3-3/4" | 3/4" |
| LUAG64 | 6/4 | 6" | .444 | 7-3/8" | 4-3/4" | 3/4" |
| LUAG56 | 5/6 | 5" | .671 | 6-7/8" | 3-3/4" | 1-5/8" |
| LUAG66 | 6/6 | 6" | .671 | 7-3/8" | 4-3/4" | 1-5/8" |
| LUAG86 | 8/6 | 8" | .671 | 9-3/4" | 6-3/4" | 1-5/8" |

Utility Anchors .444" and .671"

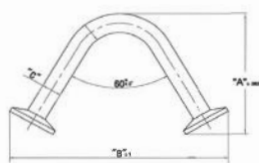

| Part Number | Min. Panel Thickness | Min. Edge Distance | Anchor Dimension | | | Safe Working Load Tension 90 | Safe Working Shear 90 | Safe Working Tension/Shear 45 |
|-------------|----------------------|--------------------|------------------|---------|--------|------------------------------|-----------------------|-------------------------------|
| | | | A | B | C | | | |
| LUAG44 | 4" | 9" | 3-1/8" | 5-1/4" | 0.444" | 3,298 | 5,277 | 2,269 |
| LUAG54 | 5" | 10" | 3-3/4" | 6" | 0.444" | 3,298 | 5,277 | 2,730 |
| LUAG64 | 5-5/8" | 12" | 4-3/4" | 7-3/8" | 0.444" | 3,298 | 7,277 | 3,150 |
| LUAG56 | 5-5/8" | 10" | 3-3/4" | 6-7/16" | 0.671" | 4,708 | 8,324 | 3,220 |
| LUAG66 | 7-5/8" | 12" | 4-3/4" | 7-3/8" | 0.671" | 7,533 | 12,053 | 5,170 |
| LUAG86 | 12" | 16" | 6-3/4" | 9-3/4" | 0.671" | 8,045 | 15,390 | 7,660 |

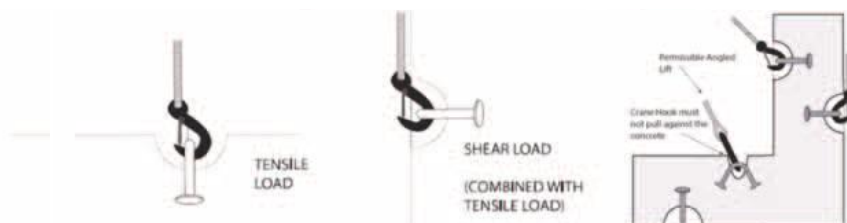

Safe Working Load provides a factor of safety of approximately 4:1.
Table is based on a minimum concrete compressive strength of 4,000 psi.

Starcon R-Anchor Rubber Former

| Product Number | Wire Dia. |
|----------------|-----------|
| R14F | 1/4" |
| R516F | 5/16" |
| R38F | 3/8" |
| R716F | 7/16" |



Utility Anchor Rubber Formers

| Part Number | Wire Dia. |
|-------------|-----------|
| LUA450 | .444 |
| LUA670 | .671 |

Utility Anchor Setting Plate

| Part Number | Former |
|-------------|--------|
| LUA45HP | LUA450 |
| LUA670HP | LUA670 |

Starcon Type-R Block Anchors

| Part Number | Size | WD | W | D | L | SWL Lbs | Weight kg |
|-------------|----------------|--------|--------|------|--------|---------|-----------|
| R1462G | 1/4" x 6" | 0.25" | 2-5/8" | 1/2" | 6" | 1600 | 0.80 |
| R516652G | 5/16" x 6-1/2" | 0.315" | 2-5/8" | 3/4" | 6-1/2" | 3200 | 0.157 |
| R3872G | 3/8" x 7" | 0.375" | 2-3/4" | 1" | 7" | 4690 | 0.24 |
| R71692G | 7/16" x 9" | 0.45" | 3-1/2" | 1" | 9" | 7500 | 0.476 |
| R716112G | 7/16" x 11" | 0.45" | 3-1/2" | 1" | 11" | 7500 | 0.57 |
| R716182G | 7/16" x 18" | 0.45" | 3-1/2" | 1" | 18" | 7500 | 0.905 |



Zap Screwlok®



Zap Screwlok – SL, Type 2 & Epoxy

Shear Screw & Wedge Coupling Sleeve

- Retrofit or repair existing structures
- Eliminate expensive rebar-welds
- Connect bars across closure pours
- No specialized equipment required. For quickest installation, use a standard air impact wrench.
- Sizes available: 10M – 55Min both Standard (SL series) and High Strength (Type 2 series)

Simple installation - Screws embed into the rebar surface while the rebar deformations interlock within the coupler wall resulting in a full positive connection for transferring tension or compression force. Available in black, epoxy-coated and galvanized finishes and for connecting two different bar diameters (transition application).



Double Barrel Zap Screwlok

Shear Screw and Double Wedge Mechanical Lap Splice

- Applications: widen bridges, slab repair, closure pours, connect hoop bars in piles to terminate spirals
- Compact Design – significantly shorter than mechanical butt splices and lap splices
- No specialized equipment needed. A standard air impact wrench is sufficient.
- Sizes available: 10M – 25M



Zap T-Lok

Shear Screw and Wedge Headed Device



- Applications: Replaces hooks and alleviates congestion.
- Field Installed: No threading required. Ideal for repair or retrofit.
- Transmits bond force from the rebar to concrete through head bearing.
- Head area- Exceeds 9Ab net bearing in tension.



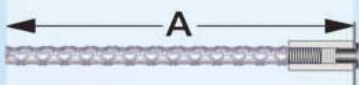
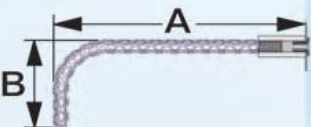
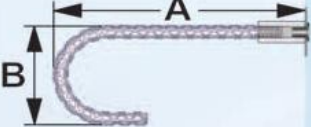
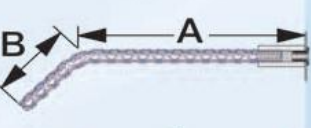

BPI Standard BarSplicer

Coupler with Standard National Coarse Threads and Flange

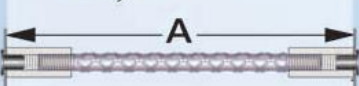
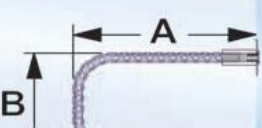
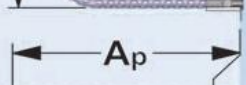
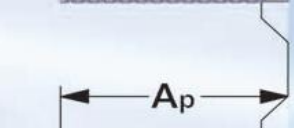
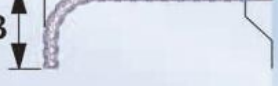
- Pre-fabricated Setting & Splice Bars – Made by BPI to your dimensions, straight, hooked, single or double ended connections, etc.
- Epoxy coated and Galvanized finished available

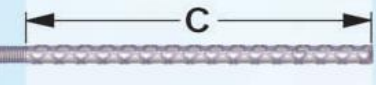
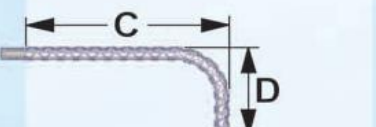
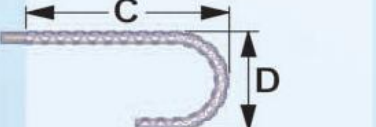
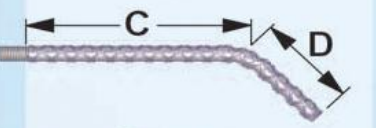
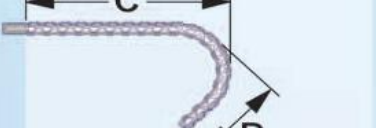
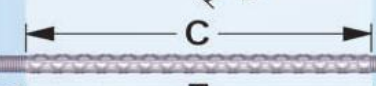
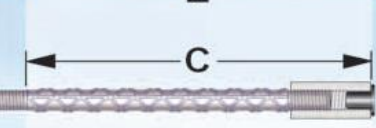
- Dowel Bar Replacement – No drilling holes through forms. Flanged couplers have holes that permit nailing to the sides or ends of formwork.
- XP Series – MTO approved. Bars supplied by BPI exceed 150% Fy, Metric Grade 400 uncoated bar.

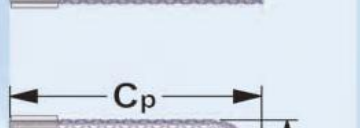
| SETTING BAR OPTIONS AND PART NUMBERS | | |
|--------------------------------------|--|---|
| BS-B | STRAIGHT Specify 'A' |  |
| BS-F | 90° BEND Specify 'A' & 'B' |  |
| BS-E | 180° HOOK Specify 'A' |  |
| BS-C | 45° BEND Specify 'A' & 'B' |  |
| BS-Q | 135° BEND Specify 'A' & 'B' |  |
| BS-A | DOUBLE END Specify 'A' |  |
| BS-D | U-SHAPE DOUBLE END Specify 'A' & 'B' |  |
| BS-J | POSITIONAL STRAIGHT Specify 'Ap' |  |
| BS-K | POSITIONAL 90° BEND Specify 'Ap' & 'B' |  |
| BS-S | HEADED STRAIGHT Specify 'A' |  |

| SPLICE BAR OPTIONS AND PART NUMBERS | | |
|-------------------------------------|--|---|
| BS-H | STRAIGHT Specify 'C' |  |
| BS-G | 90° BEND Specify 'C' & 'D' |  |
| BS-I | 180° HOOK Specify 'C' |  |
| BS-P | 45° BEND Specify 'C' & 'D' |  |
| BS-R | 135° BEND Specify 'C' & 'D' |  |
| BS-O | DOUBLE END Specify 'C' & 'Z' |  |
| BS-N | CONTINUITY DOUBLE END Specify 'C' |  |
| BS-L | POSITIONAL STRAIGHT Specify 'Cp' |  |
| BS-M | POSITIONAL 90° BEND Specify 'Cp' & 'D' |  |
| BS-T | HEADED STRAIGHT Specify 'C' |  |



BPI® BARSPLICER FLANGED COUPLER

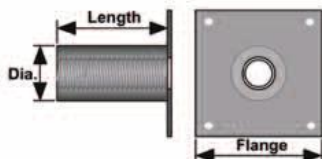

BPI® BARSPLICER POSITION COUPLER

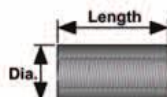

PI® BARSPLICER STRUCTURAL CONNECTOR

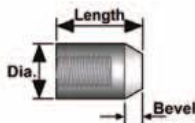

BPI® BARSPLICER DoughNUT™

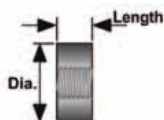

| REBAR SIZE | THREAD SIZE | WEIGHT (lbs) | LENGTH (in) | DIAMETER (in) | FLANGE (in) | BEVEL (in) |
|------------|---------------|--------------|-------------|---------------|-------------|------------|
| 4 | 1/2 - 13 UNC | 0.28 | 1 3/4 | 7/8 | 2 x 2 | — |
| 5 | 5/8 - 11 UNC | 0.35 | 2 | 1 | 2 x 2 | — |
| 6 | 3/4 - 10 UNC | 0.40 | 2 1/8 | 1 1/8 | 2 x 2 | — |
| 7 | 7/8 - 9 UNC | 0.50 | 2 1/2 | 1 1/4 | 2 x 2 | — |
| 8 | 1 - 8 UNC | 0.90 | 3 | 1 1/2 | 2 x 2 | — |
| 9 | 1 1/8 - 7 UNC | 1.50 | 3 1/2 | 1 3/4 | 3 x 3 | — |
| 10 | 1 1/4 - 7 UNC | 2.35 | 4 | 2 | 3 x 3 | — |
| 11 | 1 3/8 - 6 UNC | 2.40 | 4 1/2 | 2 | 3 x 3 | — |
| 4 | 1/2 - 13 UNC | 0.22 | 1 3/4 | 7/8 | — | — |
| 5 | 5/8 - 11 UNC | 0.30 | 2 | 1 | — | — |
| 6 | 3/4 - 10 UNC | 0.35 | 2 1/8 | 1 1/8 | — | — |
| 7 | 7/8 - 9 UNC | 0.50 | 2 1/2 | 1 1/4 | — | — |
| 8 | 1 - 8 UNC | 0.90 | 3 | 1 1/2 | — | — |
| 9 | 1 1/8 - 7 UNC | 1.50 | 3 1/2 | 1 3/4 | — | — |
| 10 | 1 1/4 - 7 UNC | 2.35 | 4 | 2 | — | — |
| 11 | 1 3/8 - 6 UNC | 2.40 | 4 1/2 | 2 | — | — |
| 4 | 1/2 - 13 UNC | 0.15 | 1 3/8 | 7/8 | — | 3/16 |
| 5 | 5/8 - 11 UNC | 0.20 | 1 1/2 | 1 | — | 1/4 |
| 6 | 3/4 - 10 UNC | 0.40 | 1 3/4 | 1 1/4 | — | 1/4 |
| 7 | 7/8 - 9 UNC | 0.50 | 2 | 1 3/8 | — | 5/16 |
| 8 | 1 - 8 UNC | 0.85 | 2 1/4 | 1 5/8 | — | 3/8 |
| 9 | 1 1/8 - 7 UNC | 1.05 | 2 5/8 | 1 3/4 | — | 7/16 |
| 10 | 1 1/4 - 7 UNC | 1.50 | 3 | 2 | — | 1/2 |
| 11 | 1 3/8 - 6 UNC | 1.55 | 3 3/8 | 2 | — | 9/16 |
| 4 | 1/2 - 13 UNC | 0.22 | 3/4 | 1 1/4 | — | — |
| 5 | 5/8 - 11 UNC | 0.37 | 7/8 | 1 1/2 | — | — |
| 6 | 3/4 - 10 UNC | 0.55 | 15/16 | 1 3/4 | — | — |
| 7 | 7/8 - 9 UNC | 0.95 | 1 1/4 | 2 | — | — |
| 8 | 1 - 8 UNC | 1.42 | 1 5/16 | 2 3/8 | — | — |
| 9 | 1 1/8 - 7 UNC | 2.15 | 1 1/2 | 2 3/4 | — | — |
| 10 | 1 1/4 - 7 UNC | 2.50 | 1 5/8 | 2 7/8 | — | — |
| 11 | 1 3/8 - 6 UNC | 3.75 | 1 7/8 | 3 1/4 | — | — |

HOW TO ORDER BPI® BARSPLICER SETTING AND SPLICE BARS

The most commonly used splice and setting bars are STRAIGHT or have a 90 DEGREE HOOK as follows...

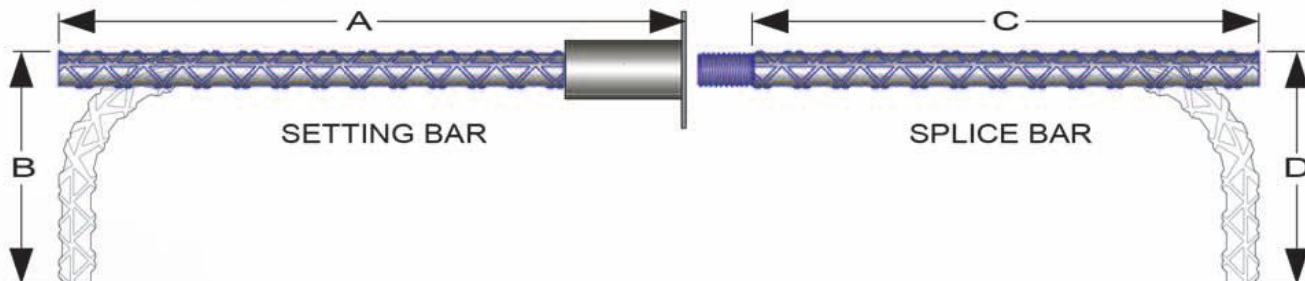

The following chart is an easy way to organize your BPI Barsplicer requirements. Many other configurations can be ordered as shown on the BPI Barsplicer configuration chart... just include the BPI PART NUMBER for easy reference.

| QUANTITY | BAR SIZE | BLACK OR EPOXY | SETTING BARS | | | | SPLICE BARS | | | | |
|----------|----------|----------------|--------------|---------------------------|---------------------------------|-----|-------------|---------------------------|---------------------------------|-----|-------|
| | | | FLANGE Y/N | BPI PART NUMBER See Chart | SPECIFY LENGTHS (FEET - INCHES) | | | BPI PART NUMBER See Chart | SPECIFY LENGTHS (FEET - INCHES) | | |
| | | | | | 'A' | 'B' | OTHER | | 'C' | 'D' | OTHER |
| | | | | | — | — | — | | — | — | — |
| | | | | | — | — | — | | — | — | — |
| | | | | | — | — | — | | — | — | — |
| | | | | | — | — | — | | — | — | — |



Korolath® is an engineered, multi-polymer plastic specifically formulated for use in the construction industry as a bearing and shimming material.

- Will not stain or rust
- Gives permanent support
- Not affected by alkali, micro organisms or rot
- Easy to use and lightweight
- Scored for use at various lengths

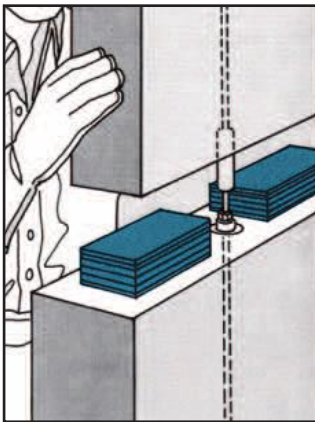

Shim Packs

Korolath® Shim Packs are pre-assembled packages of Korolath Shims that are designed for precise placing and leveling of large scale precast panels. Shim Packs should be used in grouted applications only. Custom configurations available per your requirements. Also available with heat sealed edge.

Popular sizes are: 3"x3", 4"x4", 4"x6" and 6"x6"

Scored in 2", 3" or 4" lengths for easy snap-off

Typical Shim Packs are 1-1/16" thick and consist of (1) 1/16", (2) 1/8", (3) 1/4"

Available in thicknesses from 1/2" to 2-1/16"

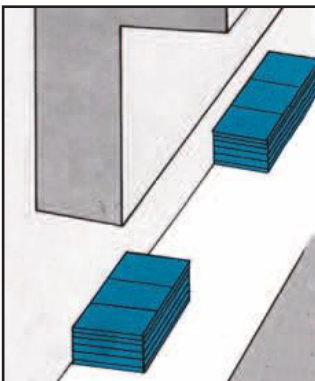

Shim Strips

Korolath® Shim Strips are available in thicknesses of 1/16", 1/8" and 1/4" in 24" lengths.

Shim Strips are scored in 2", 3" or 4" lengths for easy snap-off.

Common widths are 2", 3" and 4". Other widths are available.

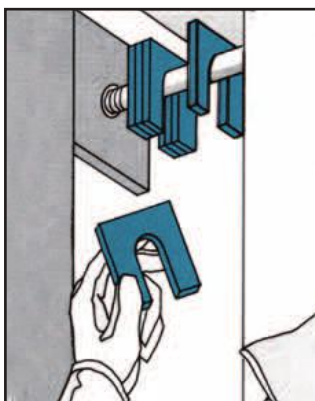

Horseshoe Spacers

Korolath® Horseshoe Spacers are commonly used in vertical applications that require a slot to fit a bolt.

Horseshoe Spacers come in thicknesses of 1/16", 1/8", 1/4", 3/8" and 1/2".

Popular sizes are: 2"x3", 3"x4", and 4"x4".

Other sizes and slot dimensions available per your requirements.

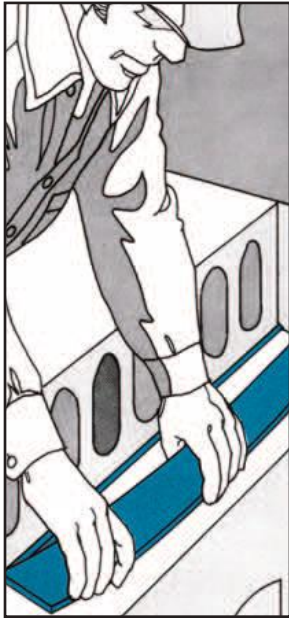

Bearing Strips

Korolath® Bearing Strips are commonly used for hollowcore planks and precast slabs. Bearing Strips come in thicknesses of 1/16", 1/8" and 1/4". Standard lengths of 40" and 48". Standard width of 24" scored in either 2", 3" and 4" intervals for easy snap off. Custom configurations available per your requirements.

Bearing Pads

Neoprene Bearing Pads are load transferring, shock impacting, and able to contract and expand where needed. They also absorb vibration and noise. Available in Neoprene in 50, 60 and 70 durometer hardness, 1/8" to 1" thick, Random Oriented Fiber (ROF), Rubber-Coated Fabric (8oz. duck cloth and synthetic rubber), and Teflon (self lubricating fluorocarbon resins). Call for further information.

CUSTOM SHIMS AVAILABLE

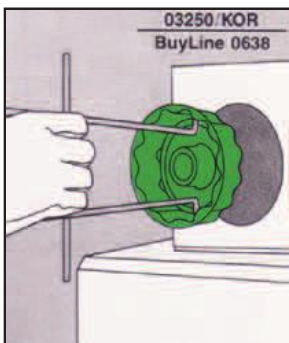
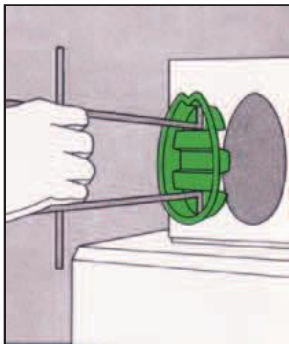

Coreplugs

- Coreplugs are supplied to the manufacturers and erectors of pre-stressed and other hollow core planks.
- The plugs are easy to insert and effectively block off grout flow to insure solid load bearing transfer through the ends of the planks on to the sills and foundation.
- Plugs push in "hard" for tight interference fit with a positive stop bar on the pusher to insure "exact" depth fill; and savings on expensive non-shrink grout.
- Fluted wall taper design can't fall over; Air escape notches prevent "no fill" pockets.
- Units are light weight, low cost and nest for convenient storage.
- Round plugs now available are 4, 4 1/2", 6, 6 3/8", 7 1/2", 7 5/8", 8", 9" and 9 5/8" in diameter. These are for plank cores such as Flexicore, Spiroll and others; Round plugs are also used to block off the ends of spiral wound paper tubes.
- Non-round plugs are available for Spancrete and Dycore – others are being developed.

CV Maxi Rebar Clips

Maxi Clips have a heavy duty design for supporting bars in vertical and horizontal steel. Maxi Clips are made for precast and site applications. Uniquely made for free flow of concrete.



CV Maxi Rebar Clips 10mm

| SKU | Cover | Bar size | lbs/Bag | Qty/Bag |
|-----------|--------|----------|---------|---------|
| MAX10-25 | 1" | #3 - #4 | 15 | 500 |
| MAX10-30 | 1 1/4" | #3 - #4 | 17 | 500 |
| MAX10-40 | 1 1/2" | #3 - #4 | 19 | 500 |
| MAX10-45 | 1 3/4" | #3 - #4 | 22 | 500 |
| MAX10-50 | 2" | #3 - #4 | 24 | 500 |
| MAX10-63 | 2 1/2" | #3 - #4 | 25 | 400 |
| MAX10-57 | 2 1/4" | #3 - #4 | 23 | 400 |
| MAX10-69 | 2 3/4" | #3 - #4 | 21 | 300 |
| MAX10-75 | 3" | #3 - #4 | 22 | 300 |
| MAX10-82 | 3 1/4" | #3 - #4 | 22 | 250 |
| MAX10-90 | 3 1/2" | #3 - #4 | 23 | 250 |
| MAX10-95 | 3 3/4" | #3 - #4 | 21 | 200 |
| MAX10-100 | 4" | #3 - #4 | 22 | 200 |
| MAX10-107 | 4 1/4" | #3 - #4 | 18 | 150 |
| MAX10-114 | 4 1/2" | #3 - #4 | 19 | 150 |
| MAX10-120 | 4 3/4" | #3 - #4 | 20 | 150 |
| MAX10-125 | 5" | #3 - #4 | 21 | 150 |

CV Maxi Rebar Clips 15-20mm

| SKU | Cover | Bar size | lbs/Bag | Qty/Bag |
|-------------|--------|----------|---------|---------|
| MAX1520-30 | 1 1/4" | #4 - #7 | 17 | 500 |
| MAX1520-40 | 1 1/2" | #4 - #7 | 19 | 500 |
| MAX1520-50 | 2" | #4 - #7 | 24 | 500 |
| MAX1520-45 | 1 3/4" | #4 - #7 | 22 | 500 |
| MAX1520-57 | 2 1/4" | #4 - #7 | 23 | 400 |
| MAX1520-63 | 2 1/2" | #4 - #7 | 25 | 400 |
| MAX1520-69 | 2 3/4" | #4 - #7 | 21 | 300 |
| MAX1520-75 | 3" | #4 - #7 | 22 | 300 |
| MAX1520-82 | 3 1/4" | #4 - #7 | 22 | 250 |
| MAX1520-90 | 3 1/2" | #4 - #7 | 23 | 250 |
| MAX1520-95 | 3 3/4" | #4 - #7 | 21 | 200 |
| MAX1520-100 | 4" | #4 - #7 | 22 | 200 |
| MAX1520-107 | 4 1/4" | #4 - #7 | 18 | 150 |
| MAX1520-114 | 4 1/2" | #4 - #7 | 19 | 150 |
| MAX1520-120 | 4 3/4" | #4 - #7 | 20 | 150 |
| MAX1520-125 | 5" | #4 - #7 | 21 | 150 |

CV Maxi Rebar Clips 25-30mm

| SKU | Cover | Bar size | lbs/Bag | Qty/Bag |
|-------------|--------|----------|---------|---------|
| MAX2530-30 | 1 1/4" | #8 - #10 | 20 | 500 |
| MAX2530-40 | 1 1/2" | #8 - #10 | 22 | 500 |
| MAX2530-45 | 1 3/4" | #8 - #10 | 25 | 500 |
| MAX2530-50 | 2" | #8 - #10 | 27 | 500 |
| MAX2530-57 | 2 1/4" | #8 - #10 | 25 | 400 |
| MAX2530-63 | 2 1/2" | #8 - #10 | 27 | 400 |
| MAX2530-69 | 2 3/4" | #8 - #10 | 23 | 300 |
| MAX2530-75 | 3" | #8 - #10 | 24 | 300 |
| MAX2530-82 | 3 1/4" | #8 - #10 | 24 | 250 |
| MAX2530-90 | 3 1/2" | #8 - #10 | 25 | 250 |
| MAX2530-95 | 3 3/4" | #8 - #10 | 22 | 200 |
| MAX2530-100 | 4" | #8 - #10 | 23 | 200 |
| MAX2530-107 | 4 1/4" | #8 - #10 | 19 | 150 |
| MAX2530-114 | 4 1/2" | #8 - #10 | 20 | 150 |
| MAX2530-120 | 4 3/4" | #8 - #10 | 18 | 125 |
| MAX2530-125 | 5" | #8 - #10 | 19 | 125 |



CV SLAB BOLSTERS are used for holding a large area of rebar or mesh in slab applications. Made of all Polyethylene Plastic for a more durable resistance. CV SLAB BOLSTER are clipped together in 5 ft. lengths. **Sold in quantities of 100 linear ft.**

| SKU | Cover | lbs/Skid | Qty/Skid |
|----------|--------|----------|----------|
| CVSLB-20 | 3/4" | 1050 | 14400 |
| CVSLB-25 | 1" | 1200 | 14400 |
| CVSLB-30 | 1 1/4" | 1200 | 12000 |
| CVSLB-40 | 1 1/2" | 1025 | 8000 |
| CVSLB-45 | 1 3/4" | 950 | 8000 |
| CVSLB-50 | 2" | 1100 | 7000 |



CV Precast Chairs X

are specially made for the pre-cast industry. Used on vertical and horizontal reinforcement-bars for architectural site concrete. Pointed legs show minimal formwork contact.

| SKU | Cover | Bar size | lbs/Bag | Qty/Bag |
|------------|--------|-----------|---------|---------|
| CVCASX-25 | 1" | 10mm-15mm | 17 | 500 |
| CVCASX-30 | 1 1/4" | 10mm-15mm | 17 | 500 |
| CVCASX-40 | 1 1/2" | 10mm-15mm | 22 | 500 |
| CVCASX-45 | 1 3/4" | 10mm-15mm | 22 | 500 |
| CVCASX-50 | 2" | 10mm-15mm | 24 | 500 |
| CVCASX-63 | 2 1/2" | 10mm-15mm | 24 | 400 |
| CVCASX-75 | 3" | 10mm-15mm | 20 | 300 |
| CVCASX-90 | 3 1/2" | 10mm-15mm | 21 | 250 |
| CVCASX-100 | 4" | 10mm-15mm | 21 | 250 |



CV PLAZ CHAIRS

are very strong rebar supports and a great alternative to metal chairs, for they are corrosion free. Uniquely designed for heavy rebar reinforcement in slabs, beams, foundations and bridge deck construction.

| SKU | Cover | Bar size | lbs/Bag | Qty/Bag |
|---------|--------|----------|---------|---------|
| CVPL-12 | 1/2" | #3 - #10 | 18 | 2000 |
| CVPL-20 | 3/4" | #3 - #10 | 14 | 1000 |
| CVPL-25 | 1" | #3 - #10 | 19 | 1000 |
| CVPL-30 | 1 1/4" | #3 - #10 | 11 | 500 |
| CVPL-40 | 1 1/2" | #3 - #10 | 13 | 500 |
| CVPL-45 | 1 3/4" | #3 - #10 | 17 | 500 |
| CVPL-50 | 2" | #3 - #10 | 20 | 500 |
| CVPL-57 | 2 1/4" | #3 - #10 | 21 | 500 |
| CVPL-63 | 2 1/2" | #3 - #10 | 24 | 500 |
| CVPL-75 | 3" | #3 - #10 | 22 | 400 |

CV Rebar End Spacers

are developed to create a protective overlapping for rebar ends in a vertical or horizontal application. The CV Rebar End pacers can space the rebar on either a 1" or 1-1/2" length from the sides of the forms and prevents surface rust of the concrete from corrosion or other construction chemicals. Solid designs and materials allow the CV Rebar Spacers to withstand heavy loads and applications.

| SKU | Cover | Bar size | lbs/Box | Qty/Bag | Qty/Box |
|---------|--------|-------------|---------|---------|---------|
| CVBT-25 | 1" | 10mm - 20mm | 25 | 500 | 500 |
| CVBT-40 | 1 1/2" | 10mm - 20mm | 24 | 400 | 400 |



CV Rebar Wheels are designed for vertical bar reinforcements in the precast & most on site applications. C V Rebar Wheels provide equal spacing for vertical bars used in walls, beams, & columns.



| SKU | Cover | Bar size | lbs/Bag | Qty/Bag |
|----------|--------|----------|---------|---------|
| CVW10-25 | 1" | #3 - #4 | 14 | 500 |
| CVW12-25 | 1" | #3 - #4 | 14 | 500 |
| CVW15-25 | 1" | #4 - #5 | 14 | 500 |
| CVW10-40 | 1 1/2" | #3 - #4 | 14 | 400 |
| CVW15-40 | 1 1/2" | #4 - #5 | 16 | 400 |
| CVW20-40 | 1 1/2" | #6 - #7 | 14 | 300 |
| CVW10-45 | 1 3/4" | #3 - #4 | 17 | 300 |
| CVW10-50 | 2" | #3 - #4 | 15 | 300 |
| CVW15-50 | 2" | #4 - #5 | 20 | 300 |
| VW20-50 | 2" | #6 - #7 | 18 | 300 |
| CVW15-63 | 2 1/2" | #4 - #5 | 37 | 250 |
| CVW20-63 | 2 1/2" | #6 - #7 | 37 | 250 |
| CVW15-75 | 3" | #4 - #5 | 25 | 135 |
| CVW20-75 | 3" | #6 - #7 | 25 | 135 |



CV Mesh Wheels

| | | | | |
|-----------|----------------|----------------|---------------|------------------|
| CVCIM-100 | (1" cover) | All Mesh Sizes | 1,000pcs./bag | (18 LBS per bag) |
| CVCIM-120 | (1 1/2" cover) | All Mesh Sizes | 500pcs./bag | (16 LBS per bag) |



CV Locking Wheels

are made to lock on to multiple rebar sizes from a #3 bar to a #6 bar. The points around the wheel create a minimal surface touch around the bar when it is installed, and our zip locking system holds the bar tightly in place to eliminate any chance of sliding. The CV Locking Wheels can be used for many concrete jobs and work such as precast structures, vaults, slabs and frames, foundations, bridges and much more.

| SKU | Cover | Bar size | lbs/Box | Qty/Box |
|---------|--------|-------------|---------|---------|
| CVWL-40 | 1 1/2" | 10mm - 20mm | 25 | 400 |
| CVWL-50 | 2" | 10mm - 20mm | 25 | 250 |



C V Panel Pads

are designed to protect precast/prestressed units from breakage during storage, packaging, and shipping. CV Panel Pads can be snapped in half to create two pcs of 2 1/2 x 3 for better spacing around the unit.

| SKU | Cover | lbs/Box | Qty/Box |
|----------|-------|---------|---------|
| CVPAD-26 | 4" | 40 | 400 |



Corner Guards

CV Corner Guards protect precast units against damages during transport. CV Corner Guards provide protection against chains and straps and also prevent them from slipping along the panel cover. CV Corner Guards are made of durable plastic.

| SKU | lbs/Box | Qty/Box |
|--------|---------|---------|
| CVCG-4 | 24 | 100 |



Made in Denmark

BSV has been manufacturing lifting grabs in Denmark for over 50 years; offering a complete line lifting clamps. The clamps listed in this catalog represent a small part of the line. Please visit our web site to see more lifting options. Weather it is a standard clamp, or custom grab, we can provide safe, high quality, lifting equipment to meet all of your requirements.

Barrier Grab Type 1507



Scissor grab type 1507 is the easy way to lift and move road barriers using a reliable mechanical ratchet system. The grab is a top quality product, designed, engineered and manufactured in Denmark.



| Grab type 1507 | Jaw length | Span | Unit weight | WLL |
|----------------|-----------------|-----------|-----------------|-------------------|
| 150700 | 47 1/4" 1200 mm | 7" 180 mm | 383 lbs. 175 kg | 4400 lbs. 2000 kg |
| 150720 | 47 1/4" 1200 mm | 7" 180 mm | 385 lbs. 175 kg | 7700 lbs. 3500 kg |
| 150730 | 47 1/4" 1200 mm | 7" 180 mm | 475 lbs. 215 kg | 9900 lbs. 4500 kg |

Black or Grey non-marking pads available.



Barrel Grab Model 685 HD

The BSV Barrel Grab is a mechanical grab designed to pick up barrels that range in diameter from 38" - 84". The model 685 HD has a safe working load of 6050 lbs. Larger capacity barrel grabs are available as a special order. This unit has a built in fork pocket.



Pipe Grab Model RG

The BSV RB series of mechanical grabs are designed to safely lift smaller diameter pipe. Standard grabs are built to suit pipe from 6" to 24". Custom grabs are available for 30" - 62" pipe. Models are available with asymmetrical arms to allow closer stacking. Can be used with optional fork yoke.



Large Block Grab Model 203/406

The BSV 203/406 Series is designed to lift large scale wall block.

Model 203 has a lifting range from 15 $\frac{3}{8}$ " - 25 $\frac{1}{2}$ ", 1650 lbs. capacity.

Model 406 (pictured) has a lifting range of 15 $\frac{3}{8}$ " - 25 $\frac{1}{2}$ ", 3300 lbs. capacity.



Shown with Optional Fork Yoke

BSV Scissor CLAMP model 760/50Z

The width of this clamp can be adjusted from 15.75" to 42". A maximum safe working load of 3,300 lbs. Extremely versatile, ideal for multi-purpose use.



Built-in Fork Pockets

BSV 32/38

The 32/38 will safely lift loads from 32" to 38" and up to 4070 lbs. This clamp will perform.



BSV Pallet Fork model PG 100/2-SSB-SBL self-balancing

This model has a spring-loaded head so that the fork always remains horizontal, loaded or unloaded.

Lifting capacity of 4,400 lbs.

Fork adjustment 15.75" – 37.4"

Height adjusts to 102"

Extensive range of forks available



BSV SCISSOR CLAMP MODEL 10-38

A lightweight clamp suitable for lifting curbs and other narrow stones. Lifts from 4" to 15" at a maximum safe working load of 1540 lbs.

Model #350

Hollow to OPSD 405.010"

Uniquely ribbed anchor sleeve.
Available in 12" and 16"

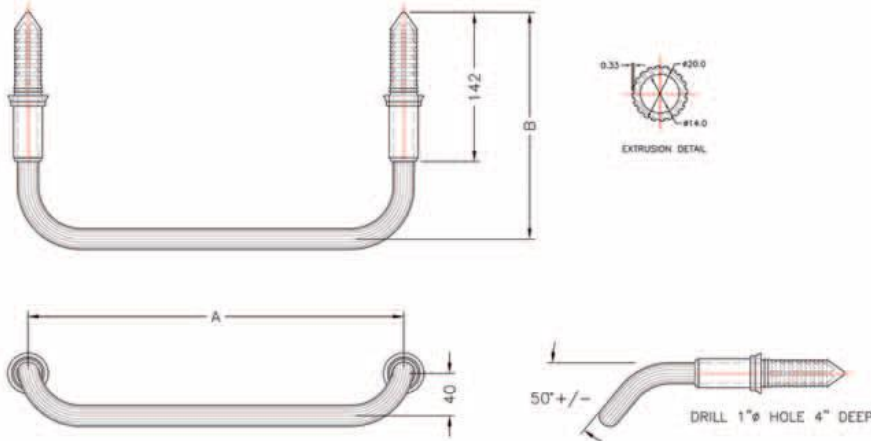

CLIMBING RUNGS

Climbing rungs allow access to and egress from your underground infrastructure.

Climbing rungs are designed for permanent installation in maintenance holes, reservoirs, pumping stations, mines, underground chambers and vaults. Climbing rungs are an alternative to ladders and are most frequently found in factory installed in precast concrete maintenance hole and valve chamber products. Suitable for curved and flat wall structures.

Model #355

Solid to OPSD 405.020
Aluminum.

Uniquely ribbed anchor sleeve.
Available in 12" and 16"

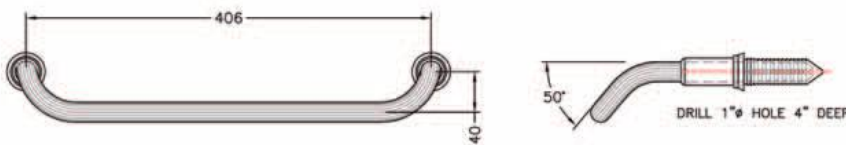

Model #360

Polyethylene coated Aluminum. Available in 12" and 16"

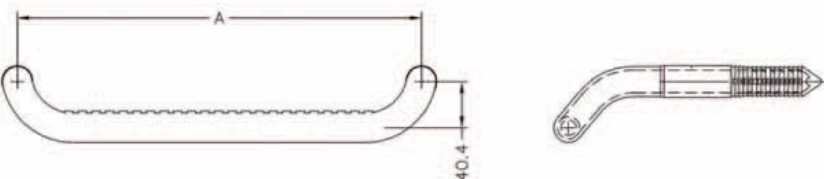

Model #380

Stainless Steel Type 316.

Welded construction to CSA standards W47.1.
Available in 16"

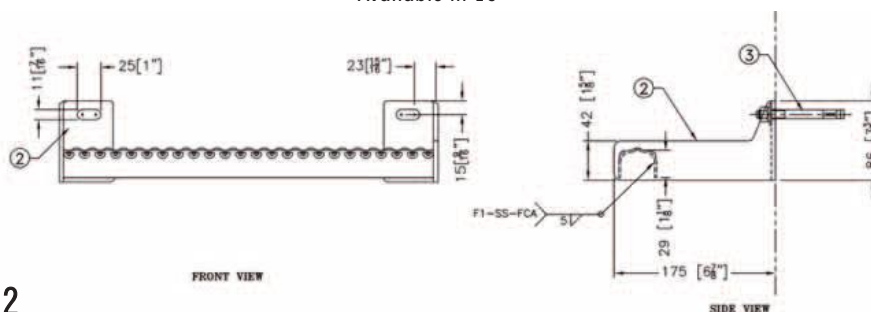

- Suitable for new construction and existing infrastructure
- Flexible installation, cast in, drive in, bolt on
- Easy to install
- Designed for permanent installation
- Meet Ontario Provincial Standard Specifications and Drawings (OPSS and OPSD), ASTM C478, and BNQ
- Slip Resistant
- Available in aluminum, polyethylene coated aluminum and stainless steel type 316
- Impervious to temperature change, impact and vibration
- Standard climbing rungs available in both 304mm and 406mm widths
- Welded construction to CSA standards W47.1 and W47.2

Climbing Rung inserts are available to suit a variety of structure diameters and manufacturing processes. These inserts ensure a consistently formed hole every time.



Fairport Paver/Block Splitter FBS40

Designed for splitting:

- Retaining Wall
- Cap Stone
- Rough Cut Face Stone
- Paving Stones
- Granite and most other flat stone materials on the market today

Spring loaded tray for angled "undercuts" when cutting pavers.

Easy one dial system: (unlike two dials) for perfect cuts every time (No need to set screw every time when cutting same size stone).

Great cutting range: New model now cuts from 0-8.3" cutting height.

| Cutting Width | Cutting Height | Weight |
|---------------|----------------|----------|
| 16" | 0" - 8.3" | 135 lbs. |



Steel Nails

Steel Nails 10" x 3/8" dia. Bright Spiral approx. 235/case 50 lbs.

Steel Nails 10" x 3/8" dia. Bright Common approx. 155/case 50 lbs.

Steel Nails 12" x 3/8" dia. Bright Spiral approx. 210/case 50 lbs.

Steel Nails 12" x 3/8" dia. Bright Common approx. 125/case 50 lbs.

48 Cases per Pallet

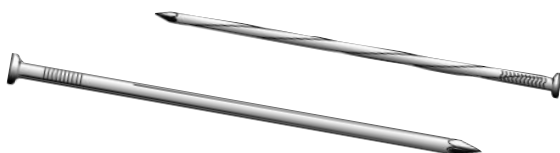

Fairport Hydraulic Block Splitter FBS65

Designed for splitting:

- Retaining Wall
- Cap Stone
- Rough Cut Face Stone
- Granite
- Paving Stones - and most other flat stone materials on the market today
- Over 20 ton cutting force

Spring loaded tray for angled "undercuts" when cutting pavers.

Adjustable blade height: for all 'flat faced' products up to 235 mm

Heavy weight construction: takes a lot of abuse.

Reversible blades: with 3 cutting edges

Length: 28.74" x Width: 32.28" x Height: 40.95"

| Cutting Width | Cutting Height | Weight |
|---------------|----------------|-------------|
| 25.6" | 0" - 9.25" | 218.26 lbs. |

Xtreme Bond Extra Strength Adhesive

Premium Polyurethane for concrete and stone is guaranteed to satisfy the highest of demands. We specially formulated our adhesive to adhere to wet or frozen surfaces. Can be used on a variety of surfaces including concrete, brick, wood, metal, stone and fibreglass. Extreme bond is formulated to work in all temperatures. **Quick adhesion and fast drying.**

- VOC compliant
- Environmentally sensitive
- Easy gunning - user friendly
- Fast curing - quicker adhesion

| | | |
|-------|----------|---------|
| L1010 | 10.5 oz. | 24/case |
| L1028 | 29 oz. | 12/case |



Confidence is the key word.

Since 1991 Landcon has been supplying concrete producers across North America with high quality, reasonably priced, accessory products. We have gone from working with a couple of local producers to supplying over 75 plants from coast to coast.

We have earned an excellent reputation for doing whatever it takes to help keep our customers production running as smoothly as possible. Whether you are around the corner, or across the country, we are here to work with you.

180 Steeles Ave. West., Suite 206, Thornhill, ON L4J 2L1

Canada – U.S. 1 866 303-3103

Tel: 416 739-7904 Fax: 416 739-9506

info@landconproducts.com

www.landconproducts.com

SERVING THE INDUSTRY SINCE 1991



SAFETY QUALITY SERVICE